

NG125 / NG150

Gas Burner

2083kW - 3924kW



NG125/150 Gas Burner features:

- Energy saving and compatible with environmental requirements
- Quiet in operation
- Reliable and trouble-free
- Designed and approved in accordance with the European Standard EN 676
- Industry standard components easily available
- 2-stage or fully modulating operation (modulation optional extra)
- Prewired control panel and simple plug-in gas train facilitates the installation
- Fully closing air damper
- Fuel: Natural Gas or LPG (Town's Gas and Biogas on request)
- Optional extras
 - Air inlet silencer
 - Separate water level control (AOTC) panel
- All kW ratings are nett CV



For more information on all Nu-way products
please visit www.nu-way.co.uk



Enertech Group

Burner Type		NG125		NG150		
Capacity	kW	2083-3293		3293-3924		
Fan Motor	V/ph/Hz	380-420/3/50		380-420/3/50		
		125-36	125-41	150-36	150-41	150-44
	kW	7.5	11	7.5	11	15
Start Current	A/each phase	57	72	57	72	92
Run Current	A/each phase	15.6	22.8	15.6	22.8	29.7
Cable size	mm ²	4	6	4	6	10
Fuse	HRC (A)	25	30	25	30	40
Control unit		LFL1		LFL1		
Operation Options		2 Stage / Mod		2 Stage / Mod		
Flame monitoring		UV Cell		UV Cell		
Air damper		Electric Actuator FCAD		Electric Actuator FCAD		
Max inlet gas pressure	mbar	300		300		
Noise @ 1m	dBA	92	94	92	94	96
Gross weight	kg	330		330		
Volume	m ³	2.344		2.344		

Other electrical supply options available on request.

Performance Fields

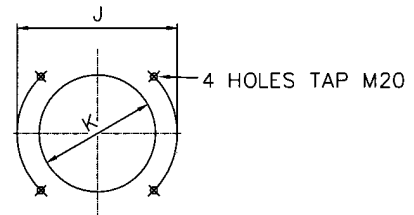
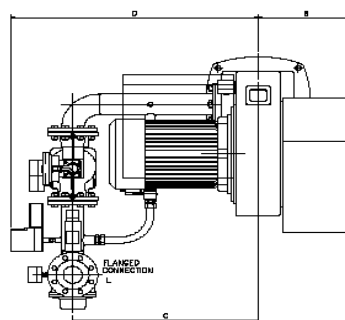
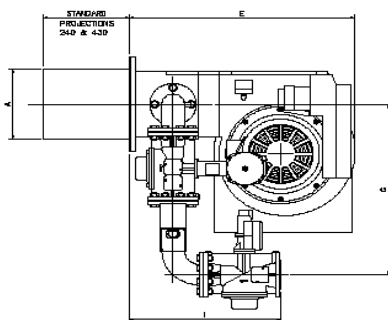
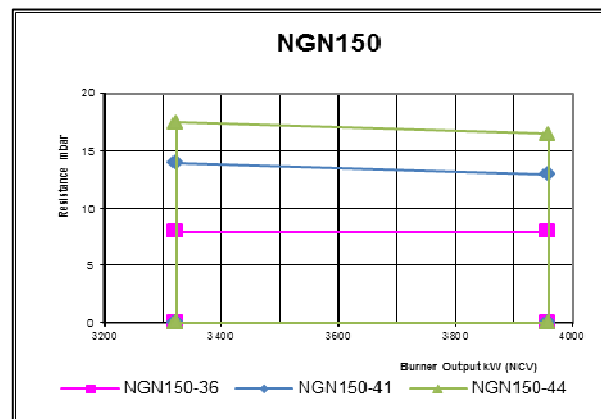
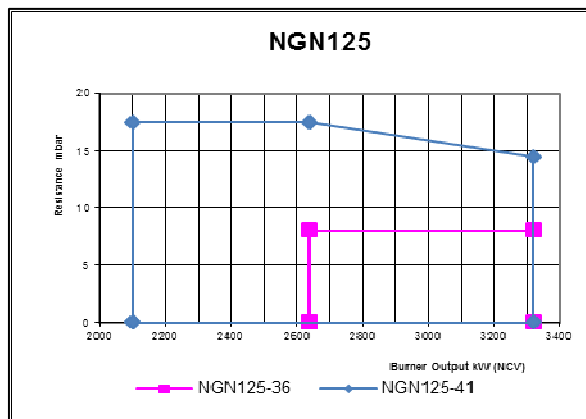

Burner	A	B	C	D	E	F	G	H	I	J	K	L
NG125-36	310	400	710	1000	906	145	760	163	590	454	330	DN65
NG125-41												PN16
NG150-36	310	400	740	1000	906	145	760	163	610	454	330	DN80
NG150-41												PN16
NG150-44												

Enertech Limited, P O Box 1, Vines Lane
Droitwich, Worcestershire, WR9 8NA

tel: +44 (0) 1905 794331 • fax: +44 (0) 1905 794017



Enertech Group
Issue 12/12